

Class 150 • Bolted Cap

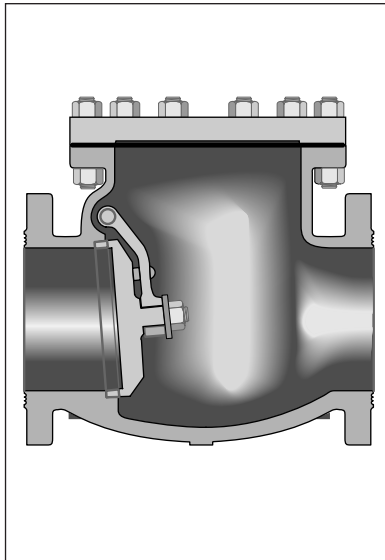

Figure 147XU
Flanged

Size Range:
2 - 24 inches

Pressure Temperature Rating
Carbon Steel
ASTM A216 Grade WCB
285 psi @ -20°F to 100°F

Materials of Construction

Description	Material
Body	A216 WCB
Cap	A216 WCB
Seat Ring	Hardfaced
Disc	13% CR Overlay
Hinge	WCB
Pins, Hinge	410 SS
Disc Washer	Steel
Cap Screw	A307 Gr. B
Cap Gasket	Soft Iron
Cap Studs	A193 Gr. B7
Cap Nuts	A194 Gr. 2H
I.D. Tags	SS
I.D. Pins	Steel

Industry Standards

Steel Valves	ANSI B16.34
Face-to-Face/End-to-End	ANSI B16.10
Flange Dimensions	ANSI B16.5
Testing	API 598
Acceptance	API RP591

Dimensions and Weights

Valve Size	Weight (pounds)	Dimensions (inches)	
		A	B Valve Open
2	33	8.00	6.75
2½	57	8.50	7.12
3	59	9.50	7.38
4	93	11.50	8.50
6	165	14.00	10.25
8	275	19.50	11.88
10	440	24.50	13.88
12	680	27.50	15.75
14	950	31.00	17.75
16	1225	34.00	19.00
18	1700	38.50	21.25
20	1850	38.50	23.58
24	2900	51.00	26.75

