

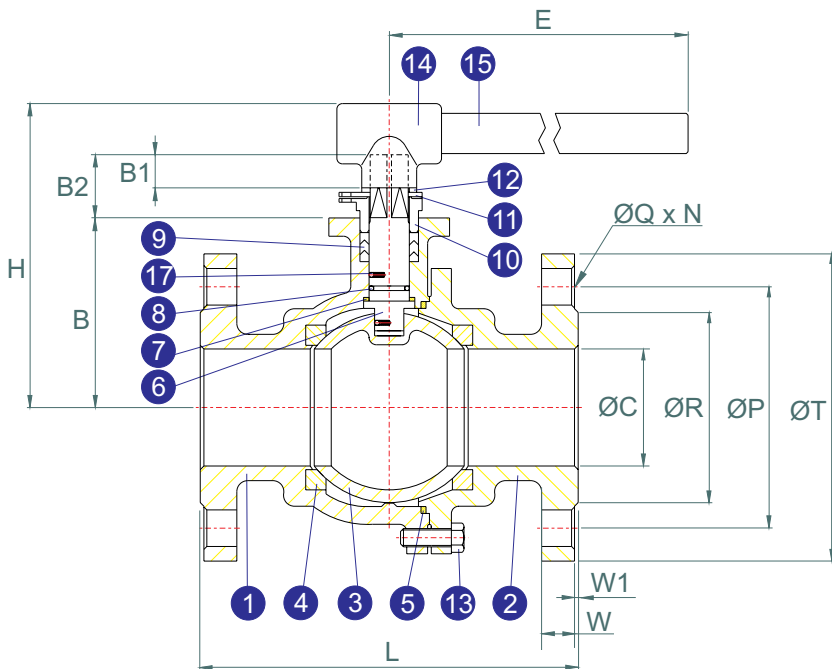

Ver. N, Model F-B1

*Split Body Flange Ball Valve
Gland Nut Design
Full Port
ANSI Class 150
5" (DN125) to 12" (DN300)*

Face-to-Face According to ANSI B16.10
Flange Dimensions According to ANSI 16.5

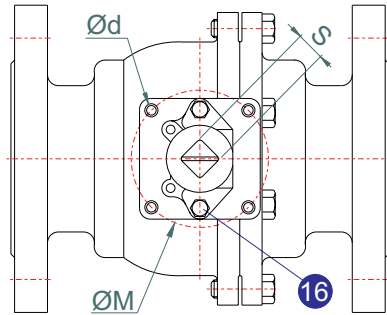

MATERIALS LIST

NO.	PART NAME	MATERIAL (Stainless)	MATERIAL (Carbon)	Q'TY
1	Body	ASTM A351 Gr. CF8M	ASTM A216 Gr. WCB	1
2	Cap	ASTM A351 Gr. CF8M	ASTM A216 Gr. WCB	1
3	Ball	ASTM A351 Gr. CF8M	ASTM A351 Gr. CF8	1
4	Seat	PTFE	PTFE	2
5	Gasket	PTFE	PTFE	1
6	Stem	AISI 316	AISI 304	1
7	Stem Seal	PTFE	PTFE	1
8	O-Ring	Viton	Viton	1
9	Stem Packing	PTFE	PTFE	†
10	Gland	ASTM A351 Gr. CF8	ASTM A351 Gr. CF8	1
11	Stop Plate	AISI 304	AISI 304	1
12	C Retainer Ring	AISI 304	AISI 304	1
13	Body Bolt	AISI 304	AISI 304	‡
14	T-Boss	FCD45	FCD45	1
15	Handle	AISI 304	AISI 304	1
16	Gland Bolt	AISI 304	AISI 304	2
*17	Anti-Static Device	AISI 316	AISI 316	2

* Available as an option

† For 5" to 12" - 3pcs

‡ For 5" to 6" - 8pcs of bolts; For 8" - 10pcs of bolts
For 10" - 12pcs of bolts; For 12" - 16pcs of bolts



Ver. N, Model F-B1

*Split Body Flange Ball Valve
Gland Nut Design
Full Port
ANSI Class 150
5" (DN125) to 12" (DN300)*

Torque Value with Lubricated PTFE Seats

SIZE	Break-Away	
	IN-LB	NM
5"	4170	470
6"	4550	520
8"	5050	570
10"	6950	790
12"	10100	1140

Note: Data listed is the maximum value taken from tested samples. 20% additional torque has been added to the torque value as safety margin. Torque value may vary due to flow media. The user is responsible for testing the actual torque prior to actuator installation. Our standard ball valve comes with lubricated PTFE seats unless otherwise noted.

Pressure Vs. Temperature Chart

for Valve 5" (Dn125) ~ 12" (DN300)

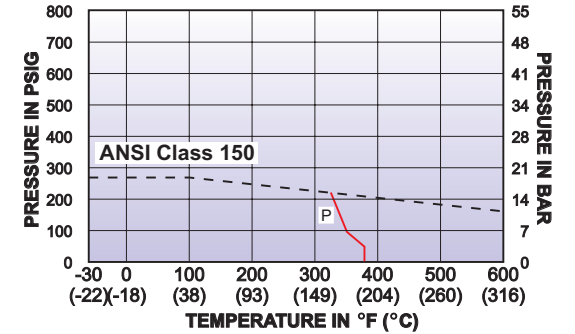

LEGEND

— P — PTFE
Seat Rating

DIMENSIONS (mm)

SIZE	ØC	ØR	ØP	ØT	L	H	B	B1	B2	E	W	W1	ØQ	N	Ød	ØM	S
5"	125	186	191	254	356	265	150	58	34	700	23.9	1.6	22	8	M12	125	28
6"	150	216	242	279	394	285	170	58	34	850	25.4	1.6	22	8	M12	125	28
8"	200	270	299	343	457	354	219	64	38	1100	28.6	1.6	22	8	M12	125	36
10"	250	324	362	406	533	390	255	64	38	1200	30.2	1.6	25	12	M12	125	36
12"	300	381	432	483	610	442	307	79	46	1500	31.8	1.6	25	12	M16	140	36