

# Limit Switch Box YT-850

Product Number: YT-850 ■ ■ ■ (specify your requirement)

Model	Switching Type	Connection Type	Bracket Type
YT-850	<span style="border: 1px solid black; padding: 1px;">M</span> Mechanical Type	<span style="border: 1px solid black; padding: 1px;">1</span> NPT1/2	<span style="border: 1px solid black; padding: 1px;">1</span> ST-1 (30*80,H20)
	<span style="border: 1px solid black; padding: 1px;">P</span> Proximity Type	<span style="border: 1px solid black; padding: 1px;">2</span> PT1/2	<span style="border: 1px solid black; padding: 1px;">2</span> ST-2 (30*80,H30)
		<span style="border: 1px solid black; padding: 1px;">3</span> PF1/2	<span style="border: 1px solid black; padding: 1px;">3</span> ST-3 (30*130,H30)
		<span style="border: 1px solid black; padding: 1px;">4</span> M20	<span style="border: 1px solid black; padding: 1px;">4</span> ST-4 (30*130,H50)



Item · Type	YT-850M	YT-850P
Switch Type	Mechanical Switch x 2	Proximity Sensor x 2
Switch Rating	AC:250V 3A, 125V 5A DC:250V 0.2A, 125V 0.4A, 30V 4A	12-24V DC (Operating voltage:10-30V DC)
Enclosure Protection	Weather proof, IP67	
Ambient Temp.	-20°C~80°C	
Conduit Entry	NPT1/2(PT1/2,PF1/2,M20,PG13.5)	
Terminal	8 Points	
Mouting Bracket	NAMUR VDI / VDE 3845, ISO 5211	
Material	Aluminum Diecasting	
Weight	880g(1.94b)	

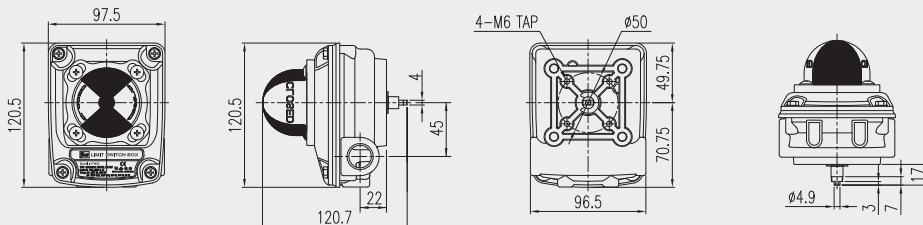

- Visual position indicator
- 6 contacts of terminal ports
- Compatibility with any rotary motion actuator <ISO5211>
- Easy adjustment of cam position
- Dual 1/2" conduit entries