

101 Series Angle Seat Valve ($\Phi 27$ cylinder)101系列角座阀($\Phi 27$ 气缸)

101-A

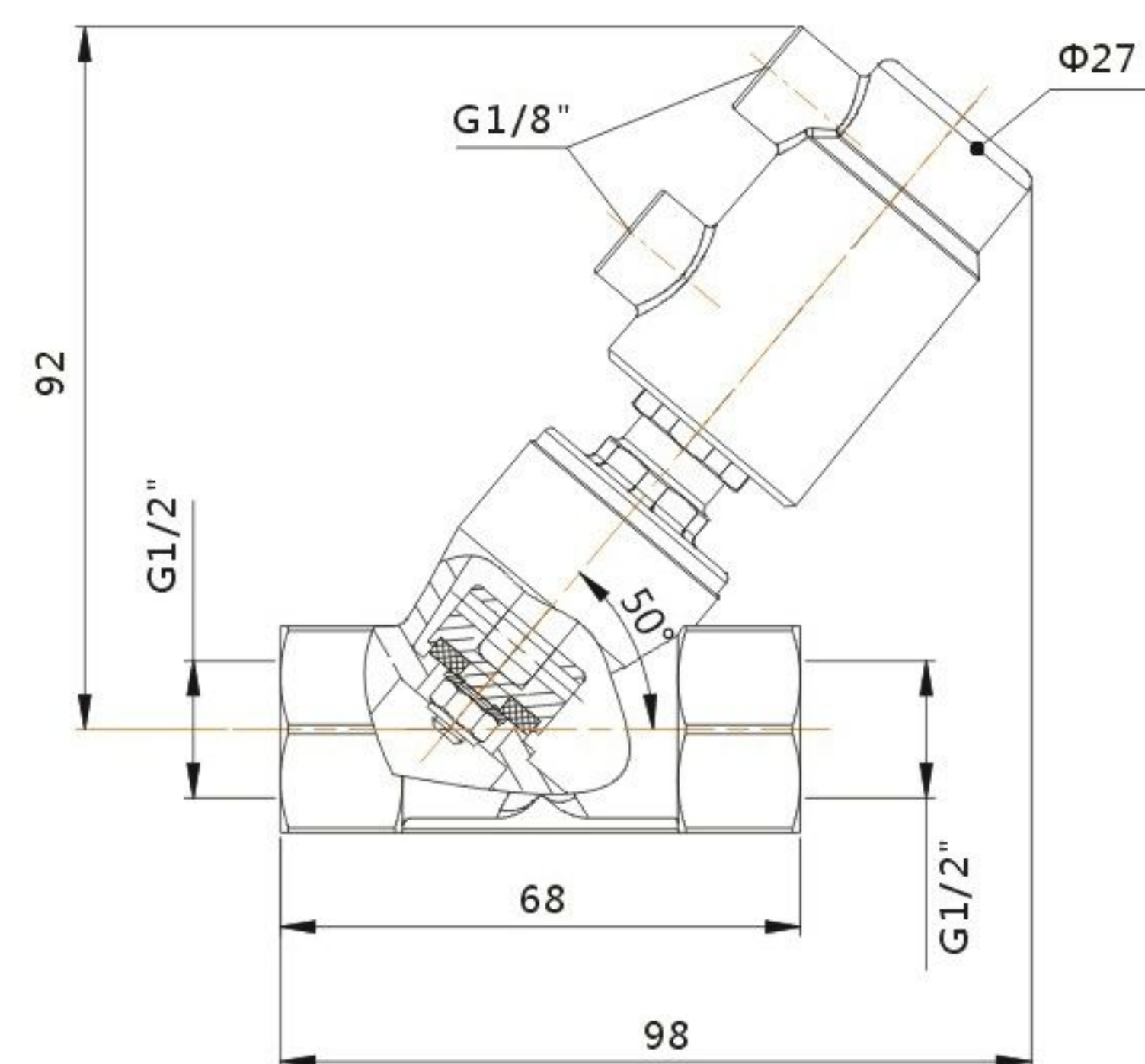

DN15灌装阀-A

101-B

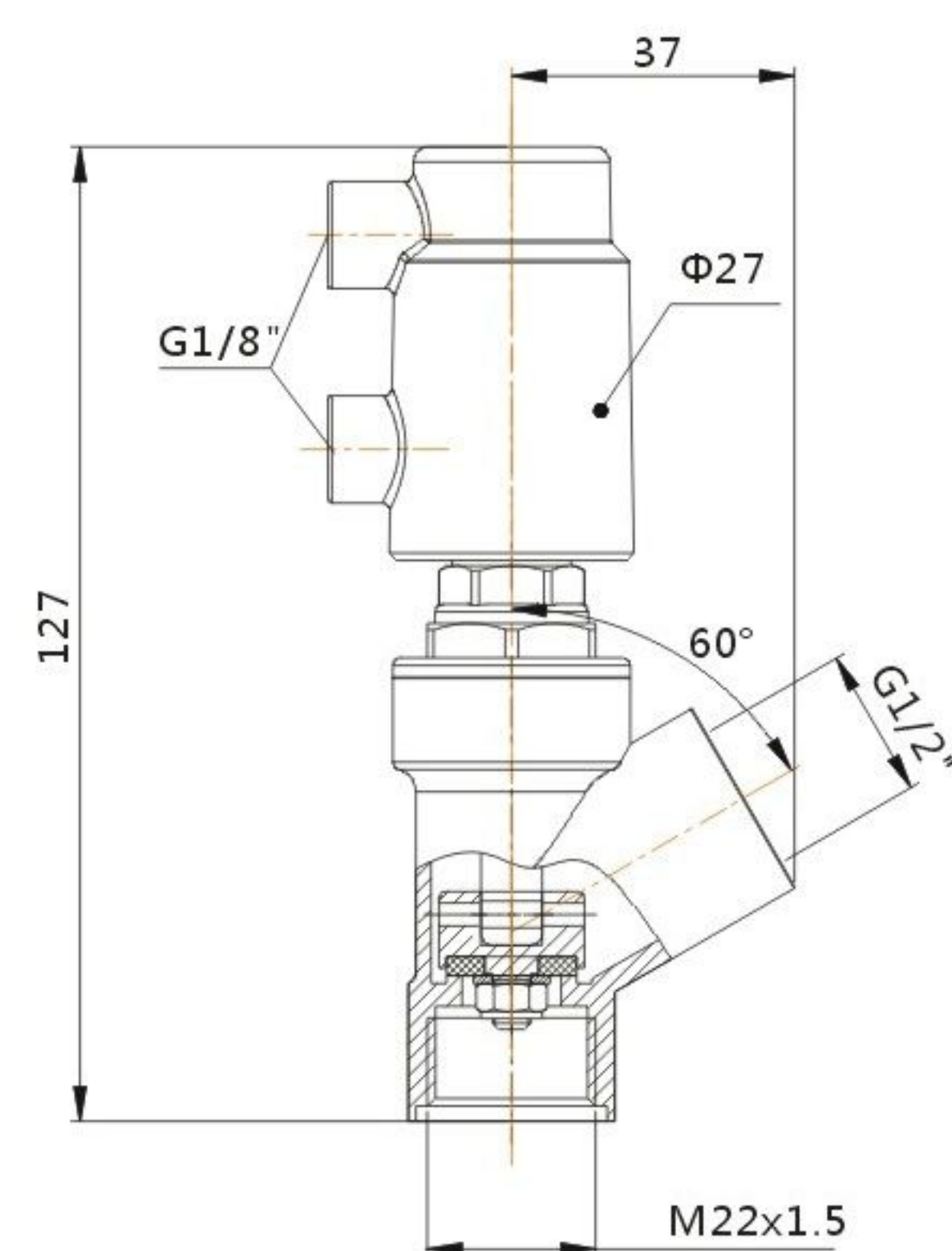

DN15立式灌装阀-B

特点:

本阀门采用精致型设计,各部件均采用不锈钢制造,外观精美,部件轻巧,结构紧凑,阀芯部位采用活动式结构,可自行校正,密封性能优良。

技术参数:

控制形式:双作用常闭型,双作用自由态
 双作用自由态:管道压力0-0.7MPa,控制压力:0.3-0.35MPa
 控制介质:经过滤的压缩空气
 阀体材质:CF8或CF8M
 密封材料:PTFE
 介质温度:-10°C-+120°C
 连接形式:螺纹式

Advantages:

Compact design, could be assembled in a small space Movable seat, which have perfect sealing.

Technical data:

Double acting(no spring): Fluid pressure: 0-7bar, Control pressure: 3-3.5bar
 Body: CF8 or CF8M
 Sealing Material: PTFE
 Fluid Temperature: -10- +120°C
 Connection: Thread(BSP, BSPT, NPT)

101 Series Angle Seat Valve ($\Phi 27$ cylinder)101系列角座阀($\Phi 27$ 气缸)ESG[®]

www.esgvalve.com

101-C

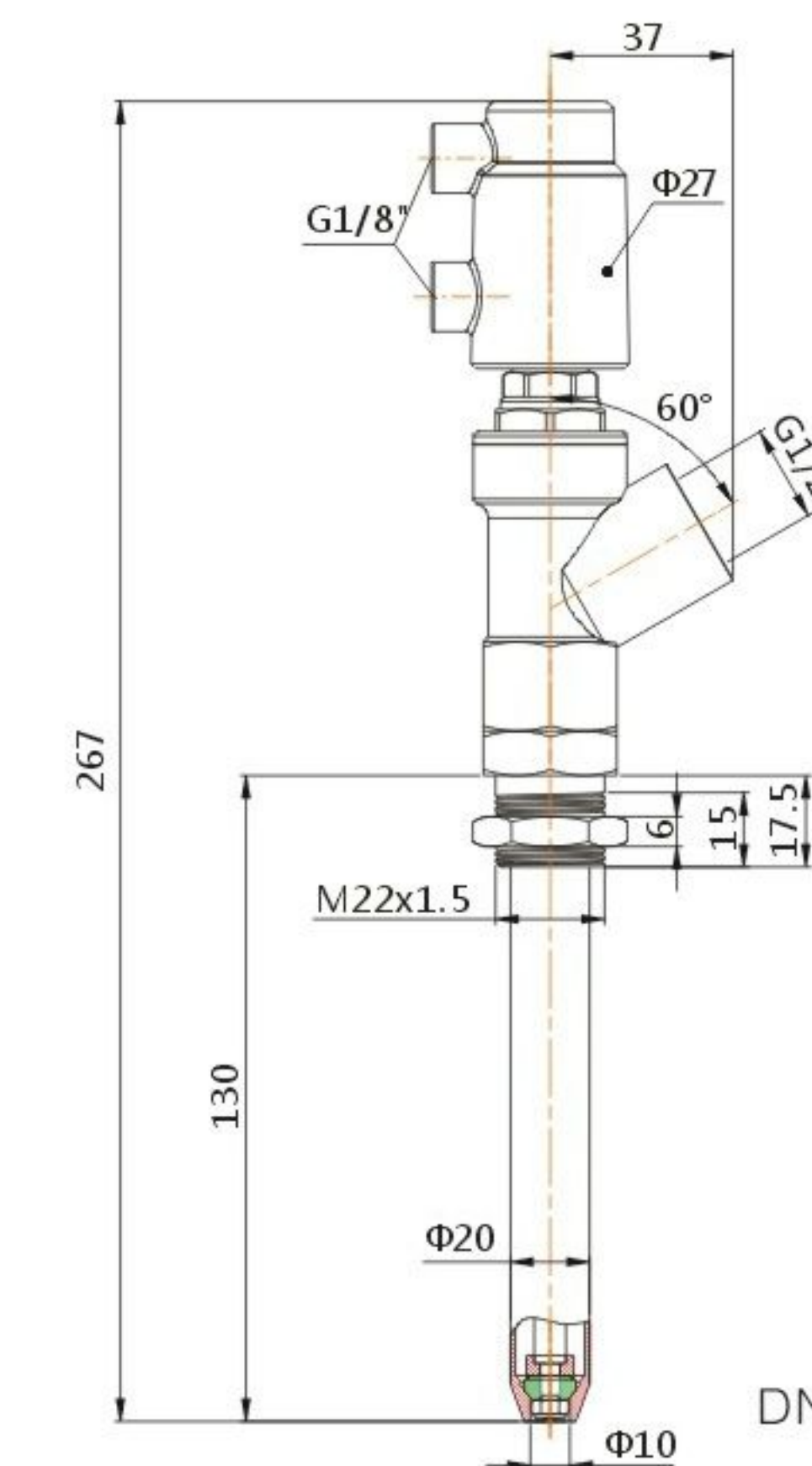

DN15加长型灌装阀-C

101-D

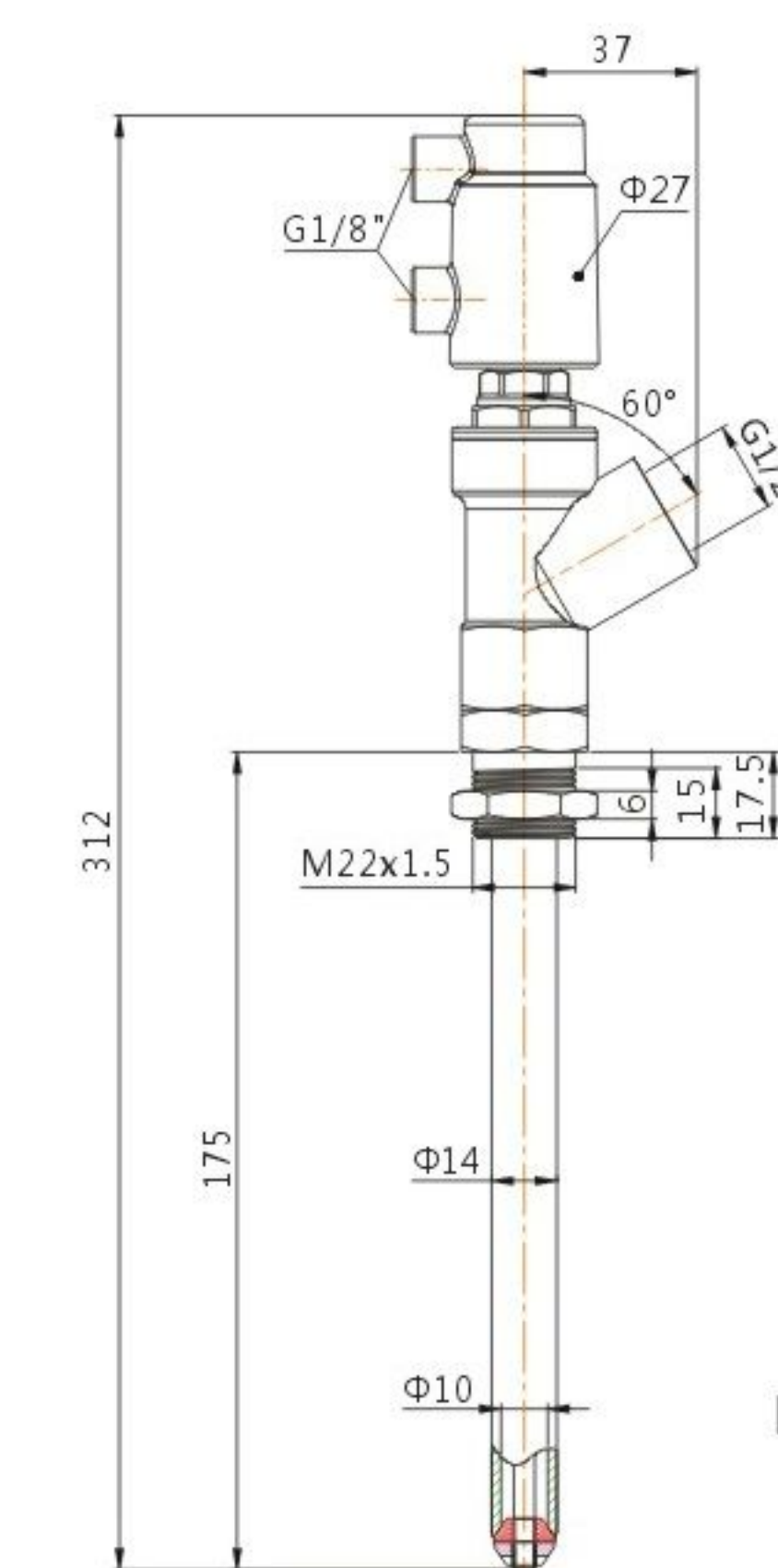

DN15加长型灌装阀-D

特点:

广泛应用于灌装机械,尤其适用于粘稠、膏状及容易起泡沫的液体灌装。
 灌装速度快,精准稳定
 精致小巧,便于排管布局
 灌装头底部特殊的密封设计,可以实现灌装无滴漏
 灌装头底部倒角结构,具有导向定位作用,可下潜灌装

技术参数:

双作用自由态:管道压力0-0.7MPa,控制压力:0.35-0.45MPa
 阀体材质:CF8或CF8M
 密封材料:PTFE
 介质温度:-10°C-+120°C

Advantages:

This valve is widely used on drinks filling machinery. The long filling gun is specially designed for high viscosity fluid.
 Fast filling, accurate and steady performance
 Compact design, could be assembled in a small space
 No dripping during working, because of special sealing design

Technical data:

Double acting(no spring): Fluid pressure: 0-7bar, Control pressure: 3.5-4.5bar
 Body: CF8 or CF8M Sealing Material: PTFE Fluid temperature: -10- +120°C

101 Series Angle Seat Valve (Φ27 cylinder)

101系列角座阀(Φ27气缸)

101-F

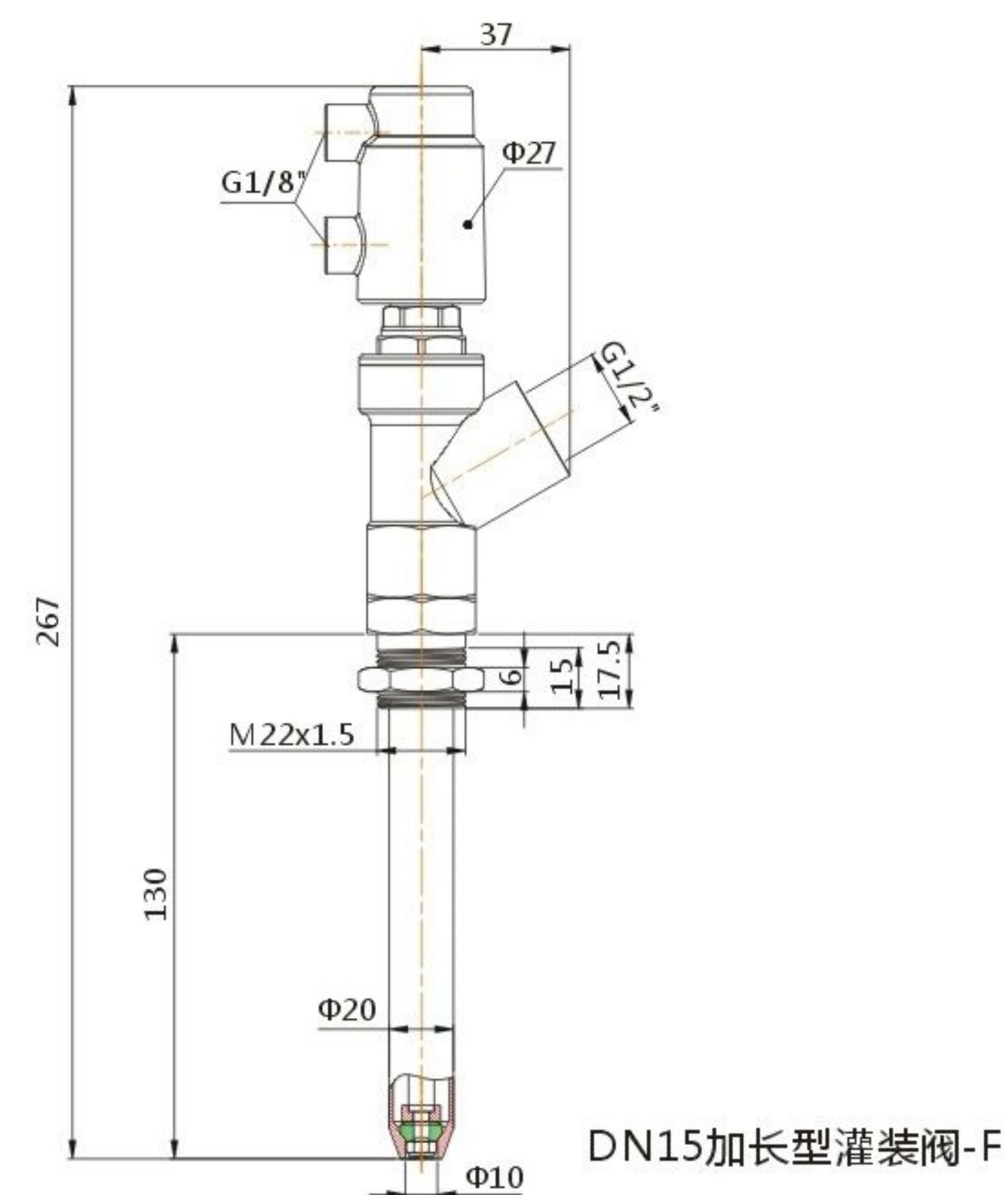

特点：

广泛应用于灌装机械，尤其适用于粘稠、膏状及容易起泡沫的液体灌装。

灌装速度快，精准稳定
精致小巧，便于排管布局
灌装头底部特殊的密封设计，可以实现灌装无滴漏
灌装头底部倒角结构，具有导向定位作用，可下潜灌装

技术参数：

双作用自由态：管道压力0-0.3MPa，控制压力：0.45-0.5MPa

阀体材质：CF8或CF8M

密封材料：PTFE

介质温度：-10℃- +120℃

Advantages:

This valve is widely used on drinks filling machinery. The long filling gun is specially designed for high viscosity fluid.

Fast filling, accurate and steady performance

Compact design, could be assembled in a small space

No dripping during working, because of special sealing design

Technical data:

Double acting(no spring): Fluid pressure: 0-3bar, Control pressure: 4.5-5bar

Body: CF8 or CF8M

Sealing Material: PTFE

Fluid temperature: -10- +120℃

102 Series Angle Seat Valve

102系列气控角座阀

ESG®

www.esgvalve.com

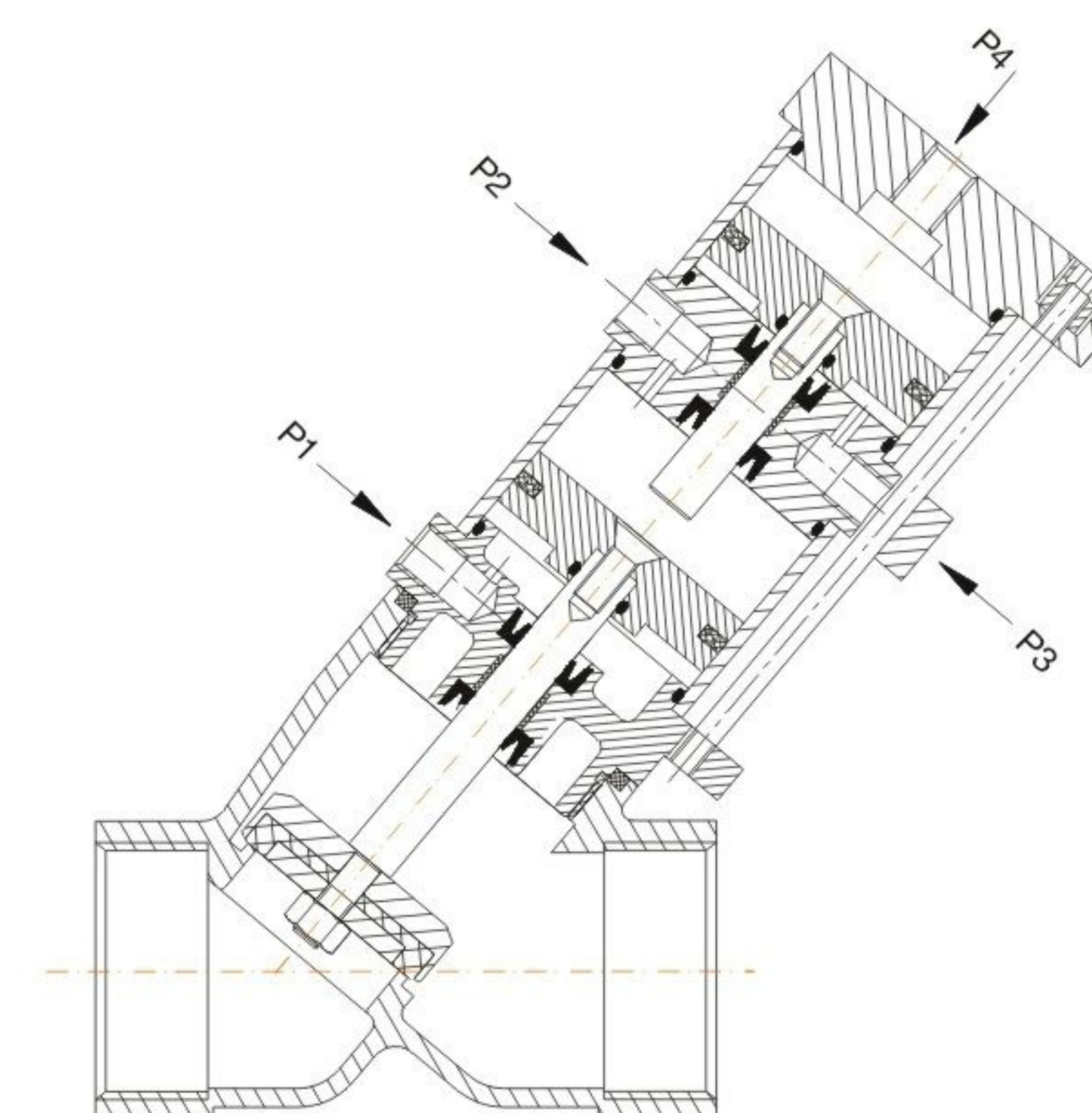

阀门特点

该阀为双位置流量可调式，当P2孔进气时，阀门关闭；当P1、P3孔进气时，阀门全开；当P4、P1孔进气时，阀门开启一半。

注：在使用过程中P3、P4孔的进气压力必须比P1、P2孔的气压高0.1MPa以上，这样阀芯才能起平衡作用。

Function

This valve is double-position flow adjustable type, which could open at 50% and 100%. When air come into the port P2, valve is closed. When the air come into the port P1 and P3, Valve is 100% opened. When air come into port P4, valve is 50% opened.

Caution:

During working, make sure the inlet Air pressure of P3 and P4 is 0.1Mpa higher than P1 and P2. Otherwise, the valve might not work well.

技术参数 Technical Data

管道压力 Fluid Pressure	0-1.6MPa
控制压力 Control Pressure	0.3-0.8MPa
控制介质 Control Fluid	中性气体或空气 Neutral gas, Air
阀体材料 Body Material	CF8M/CF8
密封材料 Seals Material	PTFE
适用介质 Applicable Fluid	水、油、气、纸浆状等液体 Water, Oil, Gas, Pulp and other liquid-like
介质温度 Fluid Temperature	-10℃—+120℃
环境温度 Ambient Temperature	-10℃—+80℃
连接形式 Connection	螺纹式，焊接式，法兰式，快装式 Threaded(BSP, BSPT, NPT), Welded, Flanged, Tri-clamp

注：规格大小可按客户要求定制加工。

Note: Could be ordered upon request.