

2PC STAINLESS STEEL 316 BALL VALVE

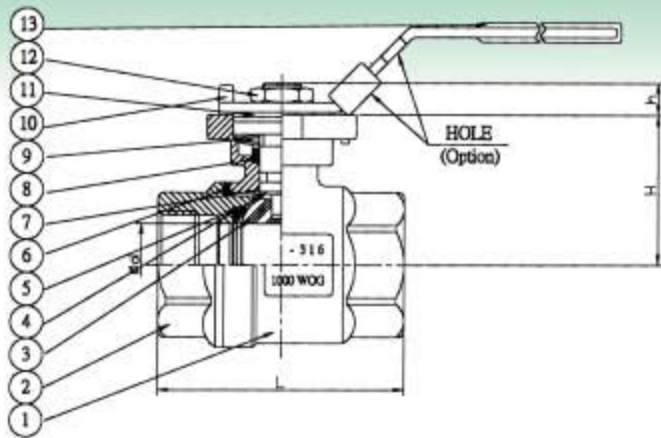

V-2AM 1000WOG



NO	PART NAME	MATERIAL	QTE
1	BODY	ASTM A351 Gr.CF8M	1
2	CAP	ASTM A351 Gr.CF8M	1
3	BALL	ASTM A351 Gr.CF8M	1
4	STEM	ASTM A276 Gr.316	1
5	SEAT	PTFE	2
6	GASKET	PTFE	1
7	THRUST WASHER	PTFE	1
8	PACKING	PTFE	1
9	BELLEVILLE WASHER	S.S.410	2
10	HANDLE	S.S.304	1
11	SPRING WASHER	S.S.304	1
12	HANDLE NUT	S.S.304	1
13	HANDLE SLEEVE	VINYL GRIP	1

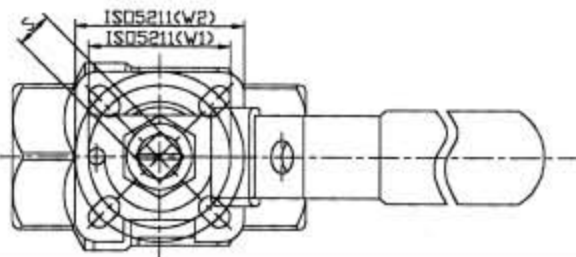

SIZE	∅d	L	H	h	S	W1	W2	ISO-5211
3 / 8"	12.5	58.0	38	7	9	36	42	F03/F04
1 / 2"	15.0	60.0	38	7	9	36	42	F03/F04
3 / 4"	20.0	70.0	42.4	9	9	36	42	F03/F04
1"	25.0	82.0	48.5	12	11	42	50	F04/F05
1 1/4"	32.0	96.0	54	12	11	42	50	F04/F05
1 1/2"	38.0	112.0	66	16	14	50	70	F05/F07
2"	50.0	126.0	74	16	14	50	70	F05/F07
2 1/2"	65.0	155.0	100.5	19	17	70	102	F07/F10
3"	80.0	170.0	109.8	19	17	70	102	F07/F10
4"	100.0	216.5	141	24	17	70	102	F07/F10